



Alban Giacomo SpA

COMPANY WITH
QUALITY SYSTEM
CERTIFIED BY DNV GL
= ISO 9001 =

TECHNICAL MANUAL

LIFT & SLIDE

AS vanishing

Scrigno - Incanto

- Lift and Slide on Scrigno vanishing counter frame.
- Sash sections 68x90 mm or greater.
- Sash with only one bottom rail with the possibility for a baseboard.
- Vertical and bottom exterior/interior gasket: balloon type with vulcanized EPDM corner.
- Top gaskets: made of PVC with fin.
- Elaprene vertical gasket for the central point with fin.
- Rear fin gasket.
- Water, air, wind, and soft body impact tests conducted with glass: 33.1/15/33.1 (minimum glass thickness allowed for cascading).
- Symmetric central point of the coaxial sashes with aluminium pin holder and end caps for closing the openings.

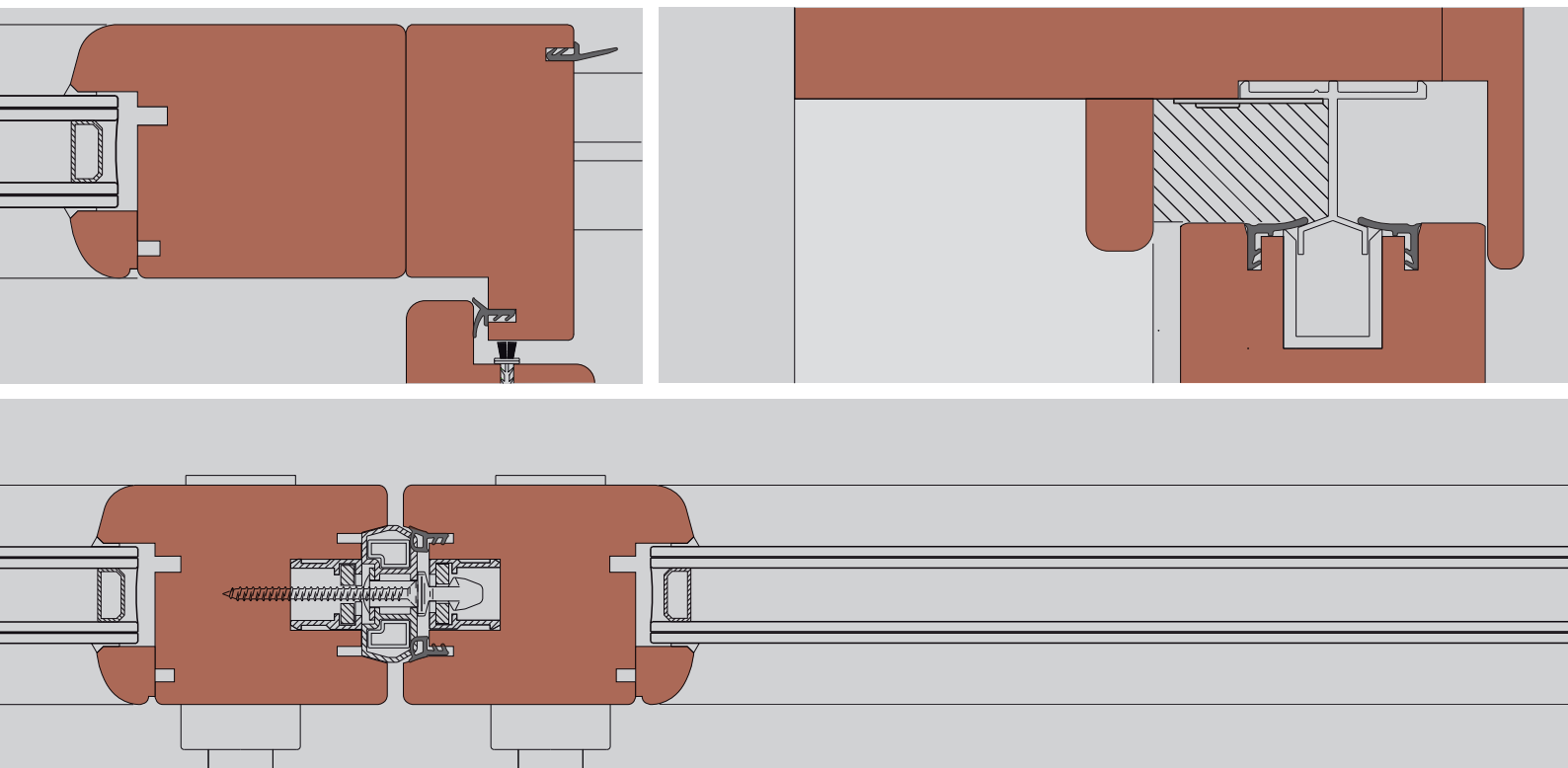

INDEX

Key legend of symbols and abbreviations	3
Hardware diagram - Sash	4
Hardware diagram - Frame	5
Calculation of the width of single sliding sash - layout A	6
Calculation of sliding sashes height - layouts A and E	7
Horizontal section - sliding sash side point	8
Horizontal section - side point	9
Vertical section - top point	10
Vertical section - Bottom point	11
Positioning the door stop	12
Wood detailing: horizontal section - lock side point	13
Wood detailing: horizontal section - side point	14
Wood detailing: vertical sections	15
Horizontal section : solution with coaxial sash - layout E	16
Wood detailing: horizontal section central point - Layout E	17
Creating lock holes	18
Mounting carriages, lock and accessories	19
Locking pins assembly	20
Locking profile for central point with symmetric coaxial sashes detail	21
Sash component measurements and techniques for air-water tightness	22
Frame component measurements and techniques for air-water tightness	22



Notice of any new developments regarding accessories, assembly and work on casements shall be provided on an ongoing basis with periodic updates of this manual. We therefore recommend particular attention to publication of new versions via the www.agb.it site







Window and door manufacturers benefitting from the AGB cascading contract are required to install glass with the following minimum requirements:

Minimum thickness 33.1/15/33.1 Shatterproof

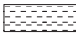

The maximum dimensions of the counter frame may not correspond to the fields of application indicated in the hardware diagram.

Key legend of symbols and abbreviations

-  = Silicone or suitable gasket
-  = Neutral silicone bead with Primer
-  = Polyurethane foam
-  = Polyethylene
- LB** = Door width
- HB** = Sash height
- H** = Architectural height
- L** = Architectural opening
- Li** = Internal opening
- M** = Component size (height/ length)

N.B. All measurements are expressed in millimetres

Hardware diagram - Frame

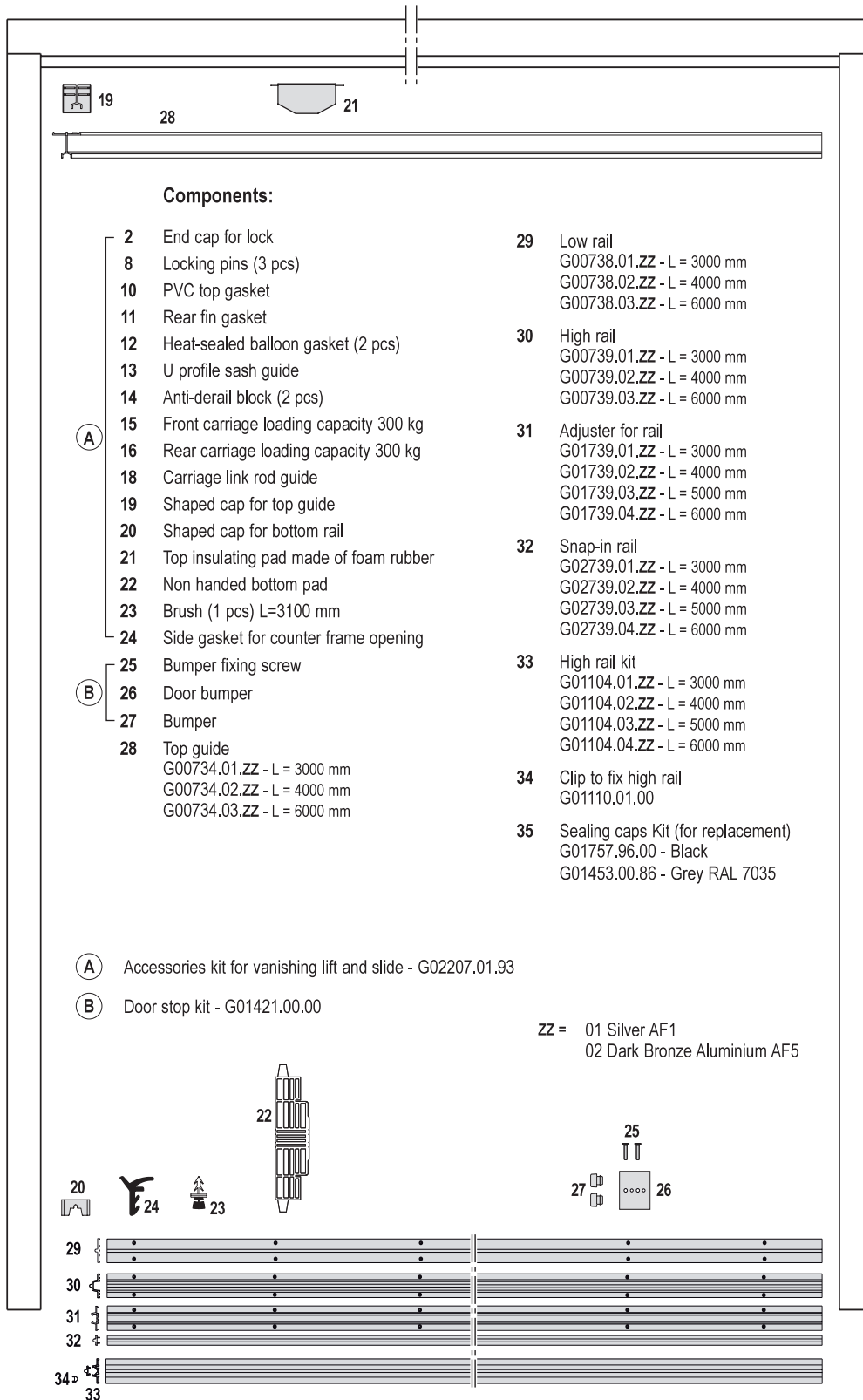

The following screws are required for assembly:
3,5x30mm 3,5x35mm 4,5x35mm 3,5x45mm 4,5x60mm 4,5x65mm

Calculation of the width of single sliding sash - layout A

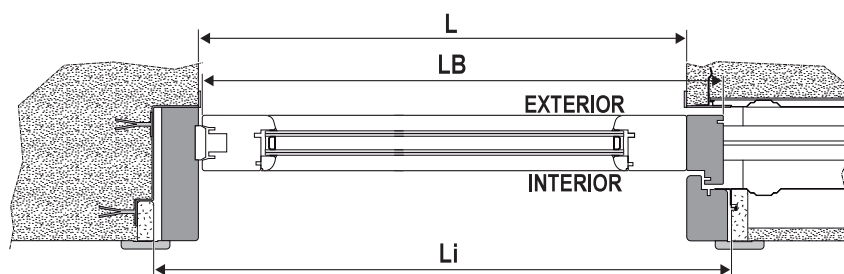
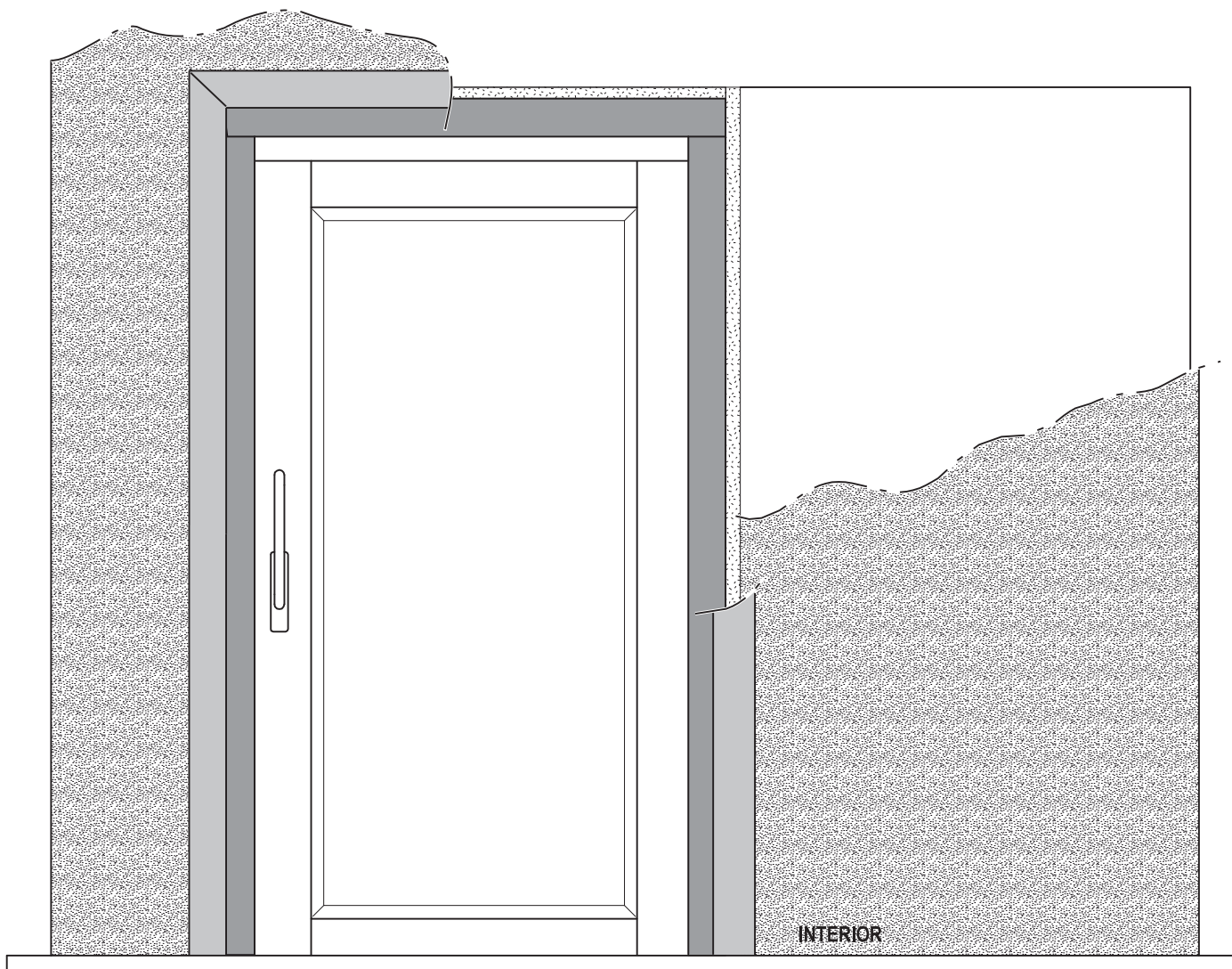

$LB = L + 40 \text{ mm}$
 $Li = L + 110 \text{ mm}$
LB = Sash Width
L = Architectural opening



LB minimum = 690 mm

Calculation of sliding sashes height - layouts A and E

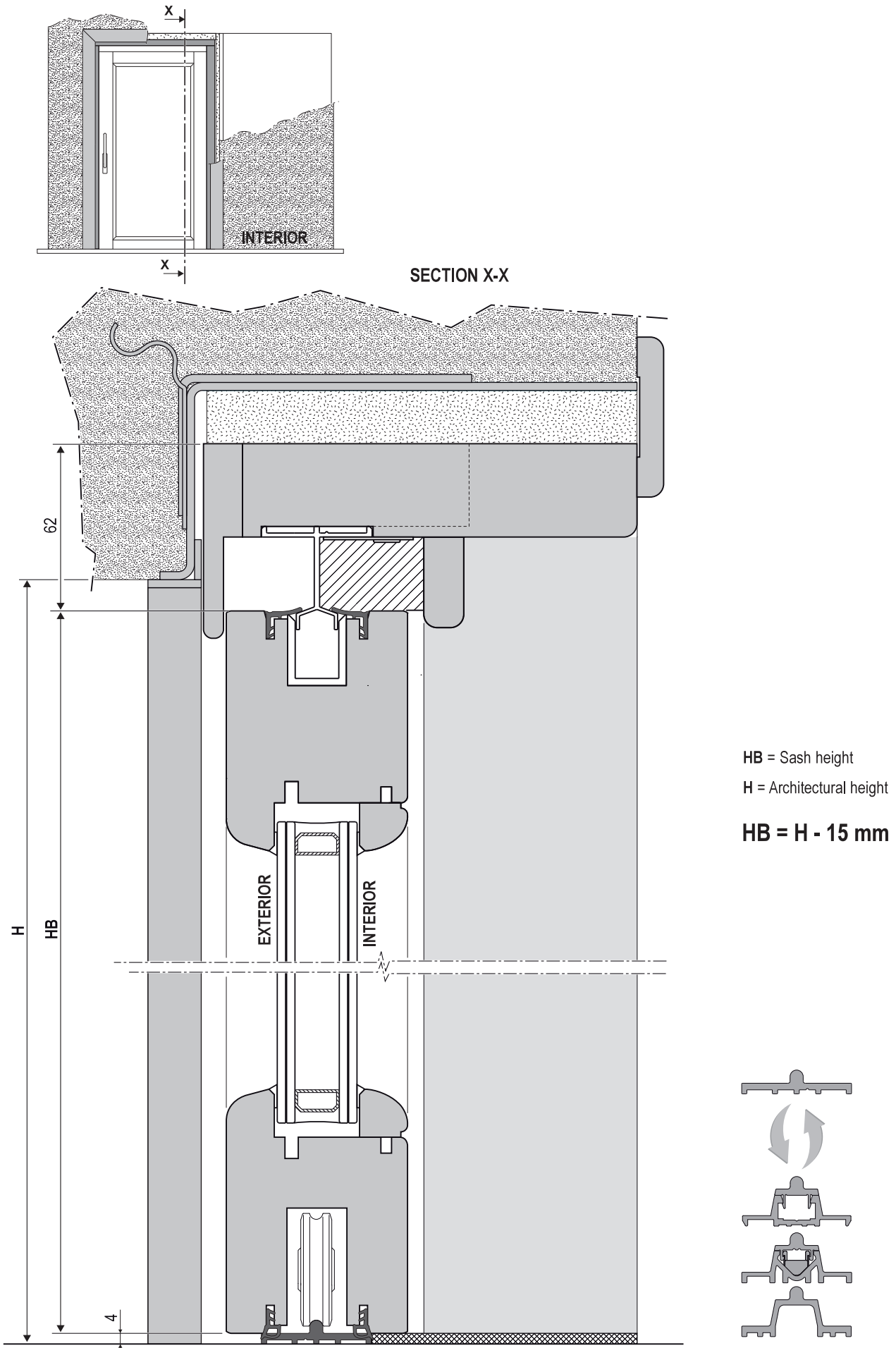

Horizontal section - sliding sash side point

Scale 1:2

TOP POINT DETAIL

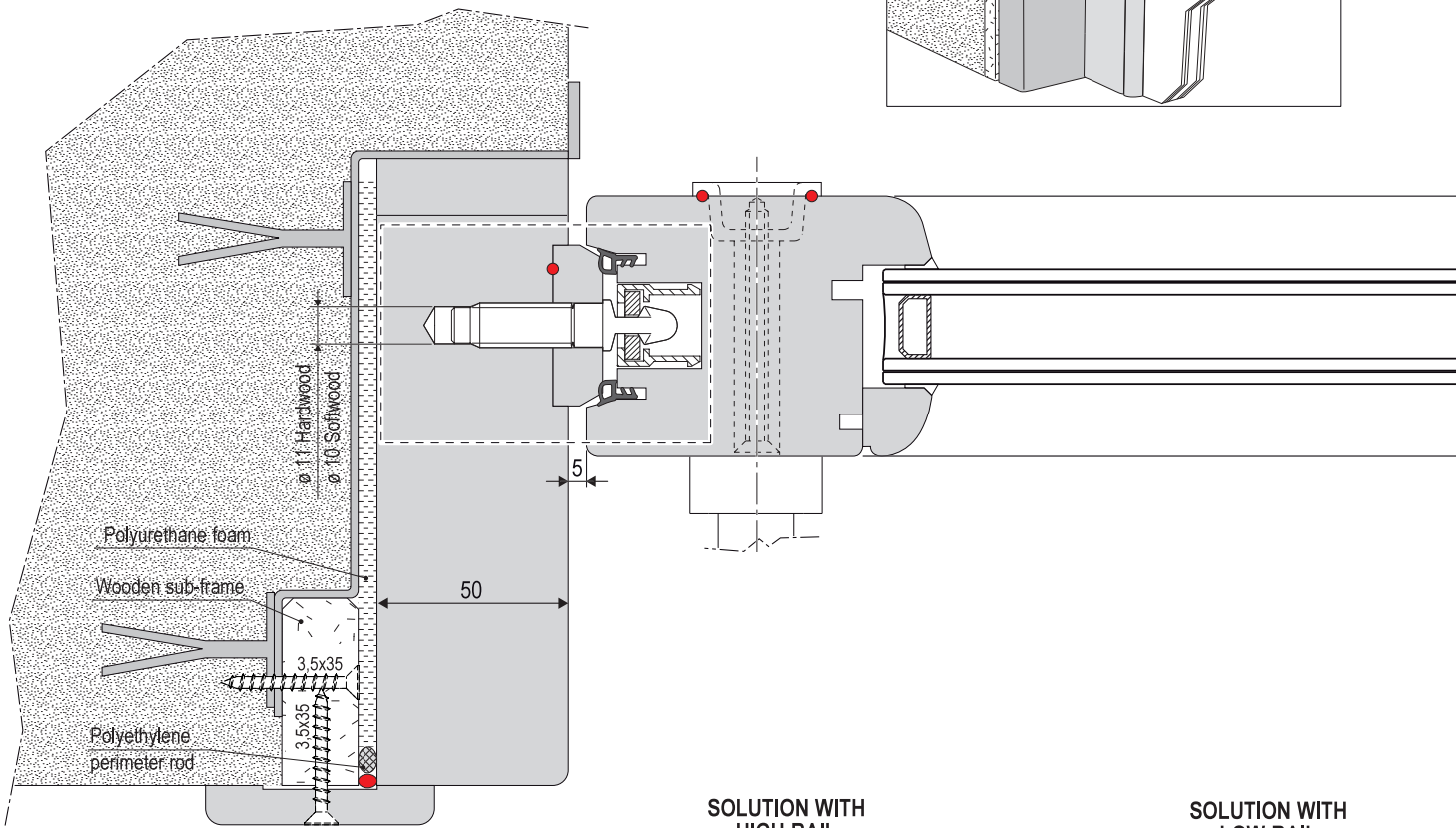
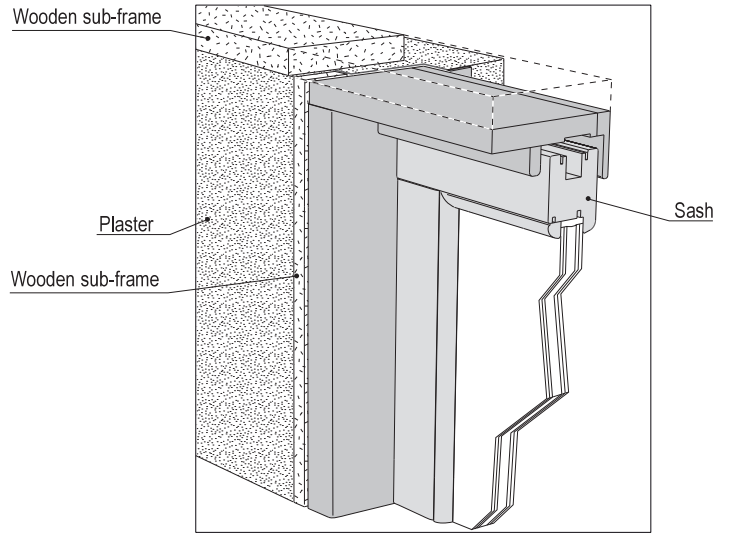
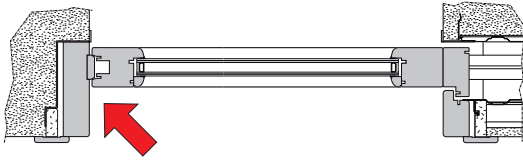

ALTERNATIVE SOLUTION WITH LOCKING PROFILE ALUMINIUM PIN HOLDER

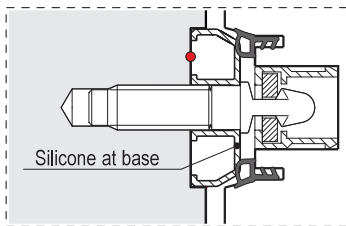

SOLUTION WITH HIGH RAIL

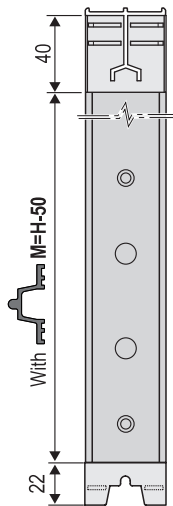

SOLUTION WITH LOW RAIL

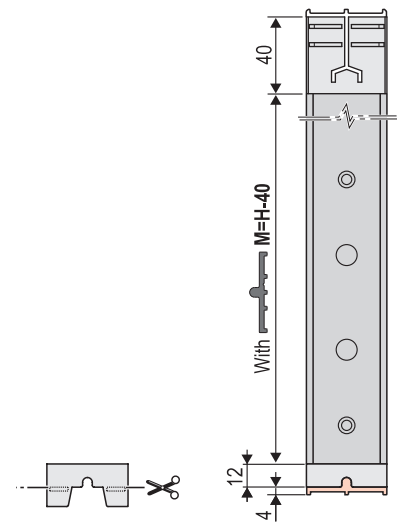

Horizontal section - side point

Scale 1:2

TOP POINT DETAIL

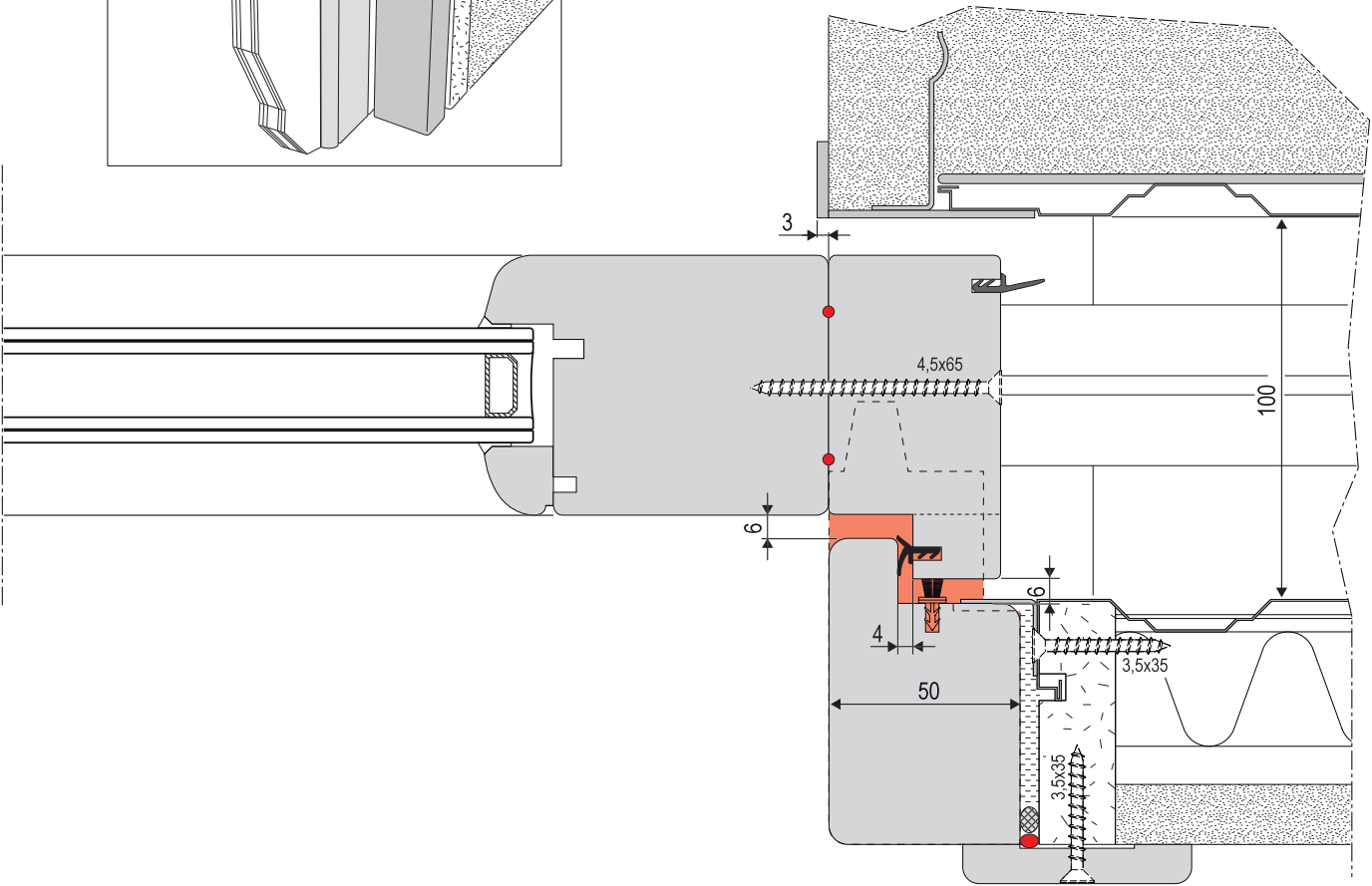
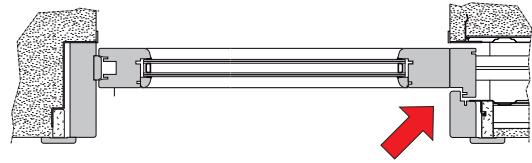
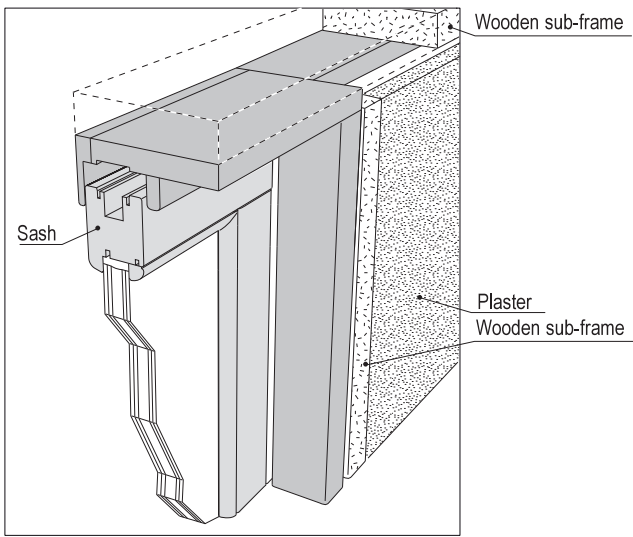

CUT BOTTOM PAD FOR COUNTER FRAME

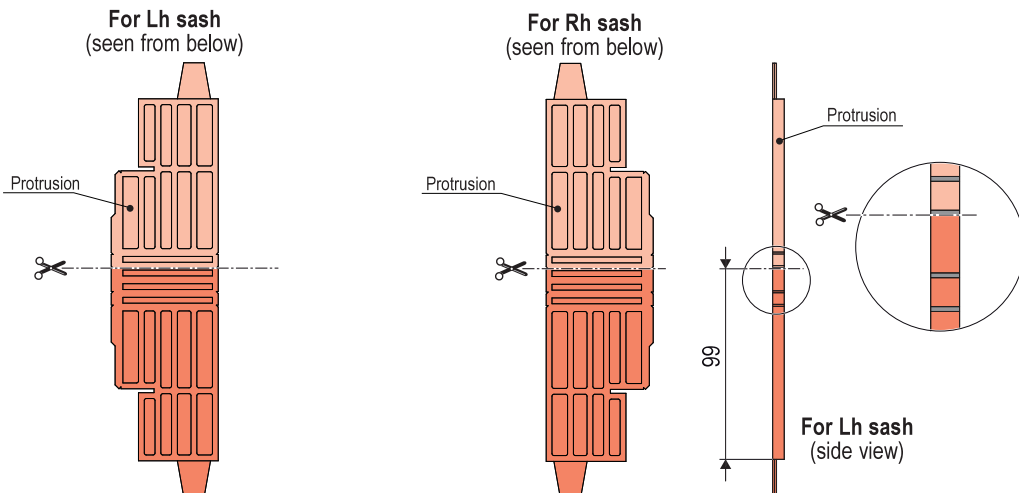

Vertical section - top point

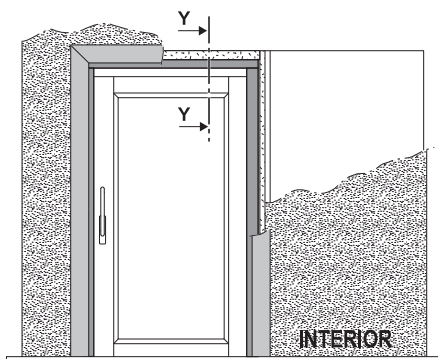

POSITIONING THE TOP INSULATING PAD

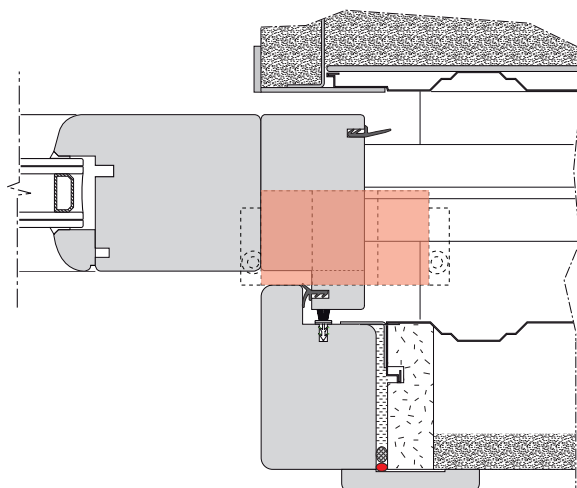

CUT TOP INSULATING PAD

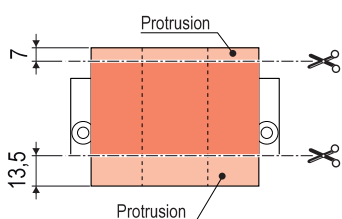

SECTION Y-Y - Scale 1:2

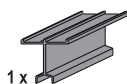
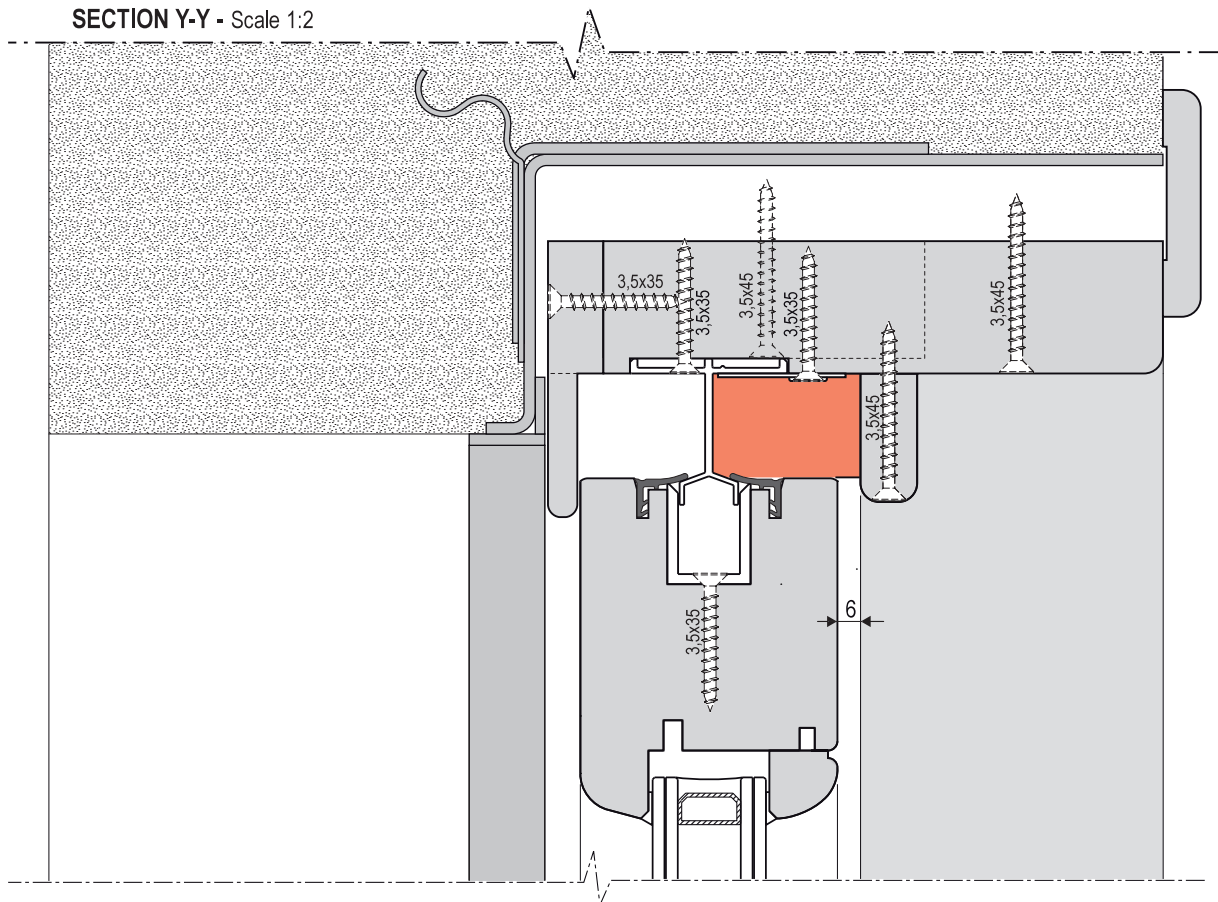

1x

$$M = 2xL+43$$

Vertical section - Bottom point

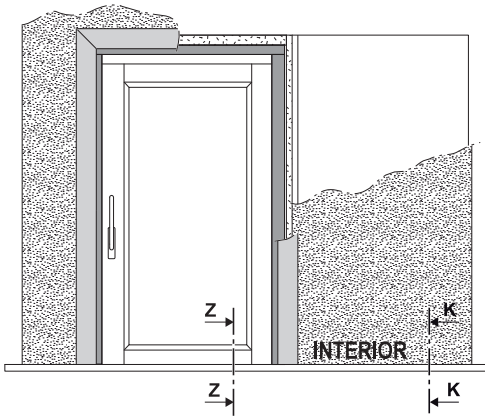

SECTION K-K - Scale 1:2

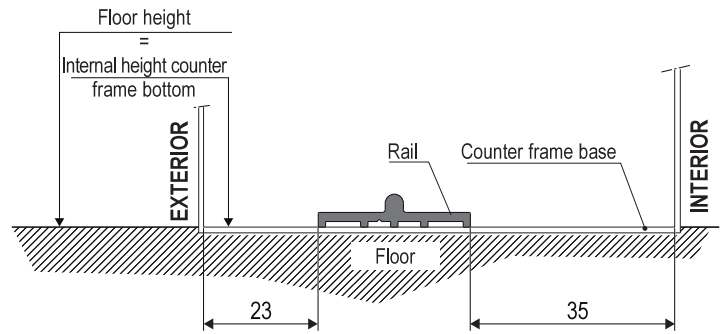

SECTION Z-Z - Scale 1:2

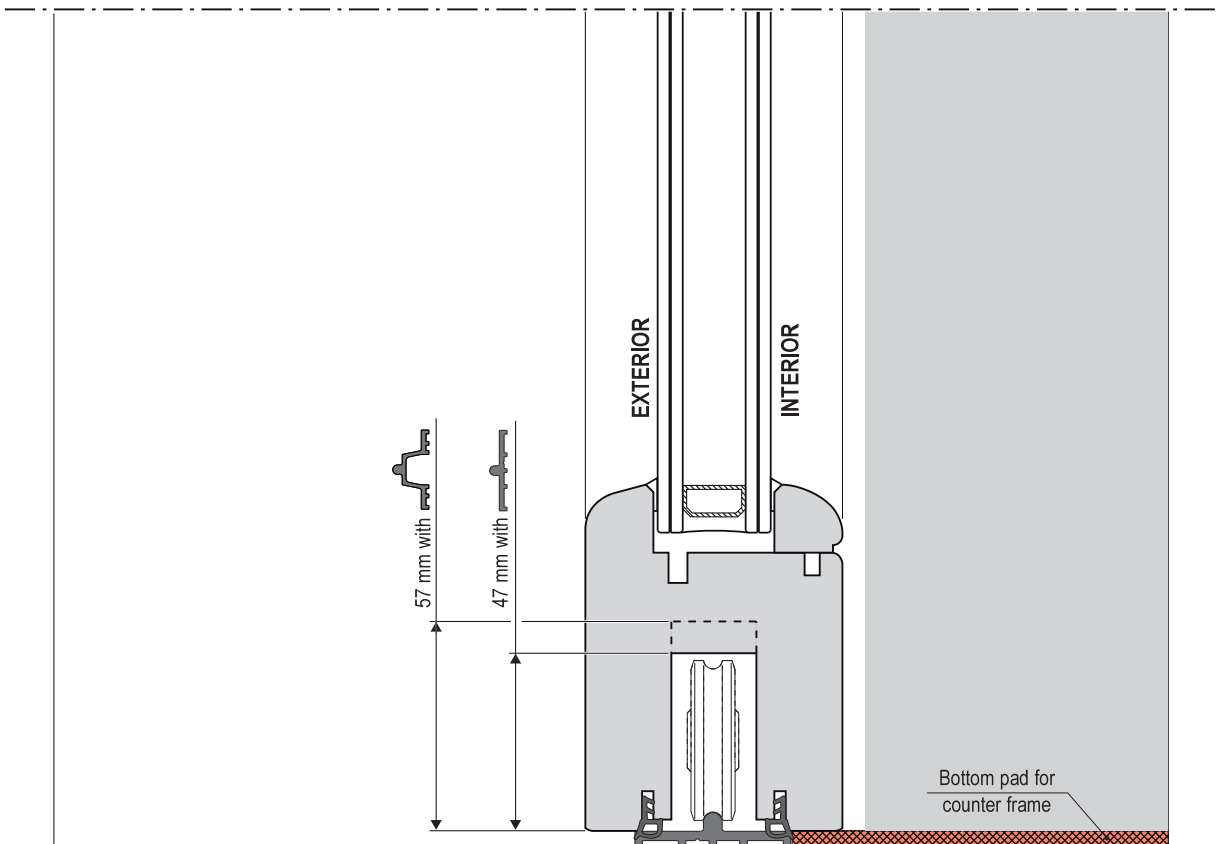

1x

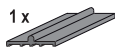

$$M = 2xL + 43$$

Positioning the door stop

POSITIONING THE BUMPER FOR DRILLING HOLES

Position the bumper at the indicated distance with the rubber washer holes positioned toward the sash (during this step do not install the rubber caps)

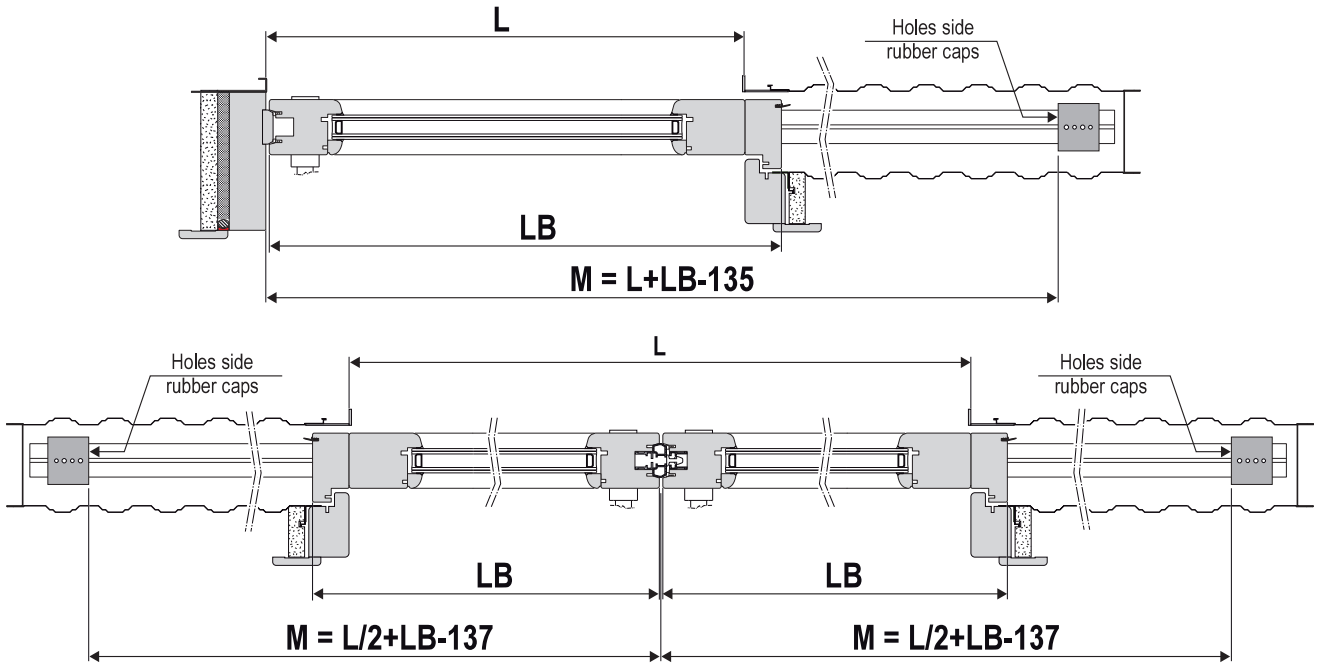

DRILLING RAIL

Drill holes in the rail using the designated holes of the bumper as a jig

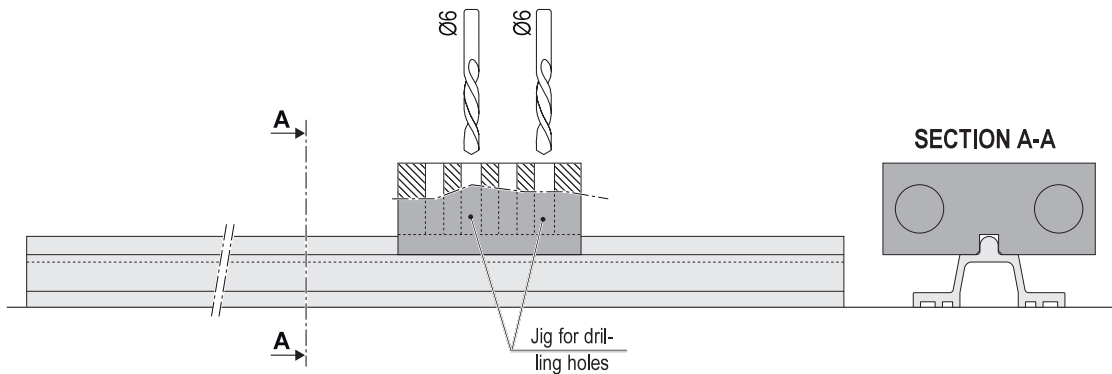

ATTACHING THE BUMPER

Install the rubber caps in the designated seats of the bumper; Secure the bumper using the screws included in the kit.

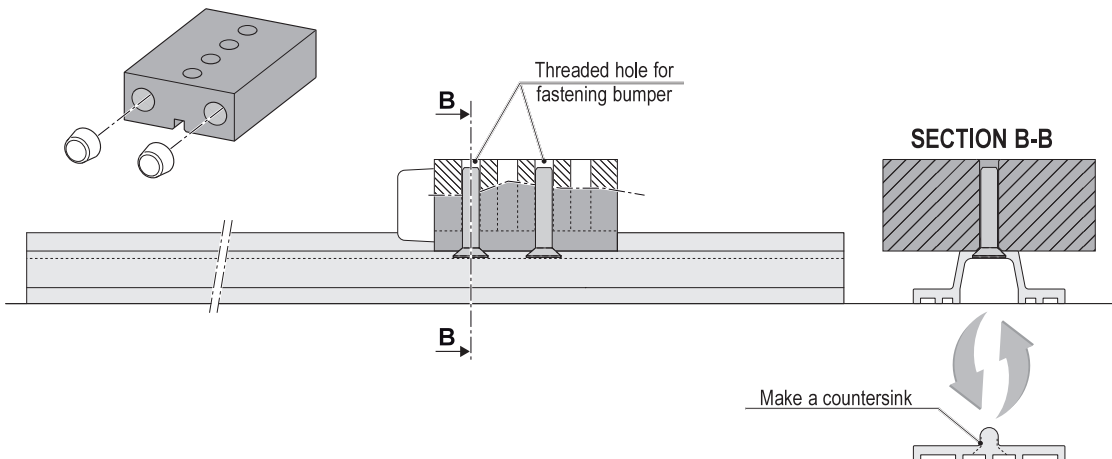

Wood detailing: horizontal section - lock side point

Scale 1:1

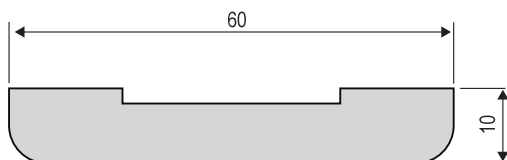
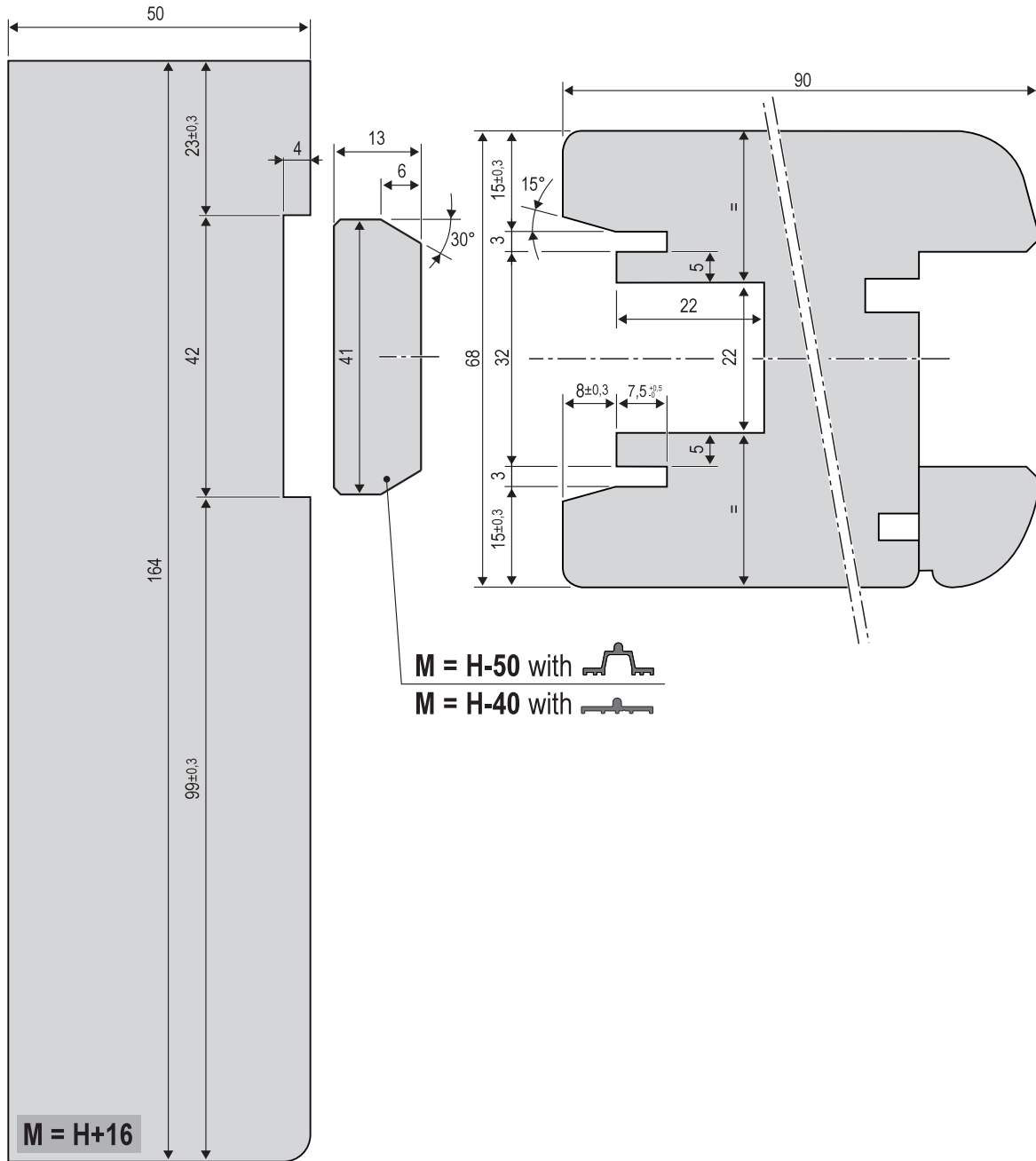

Wood detailing: horizontal section - side point

Scale 1:1

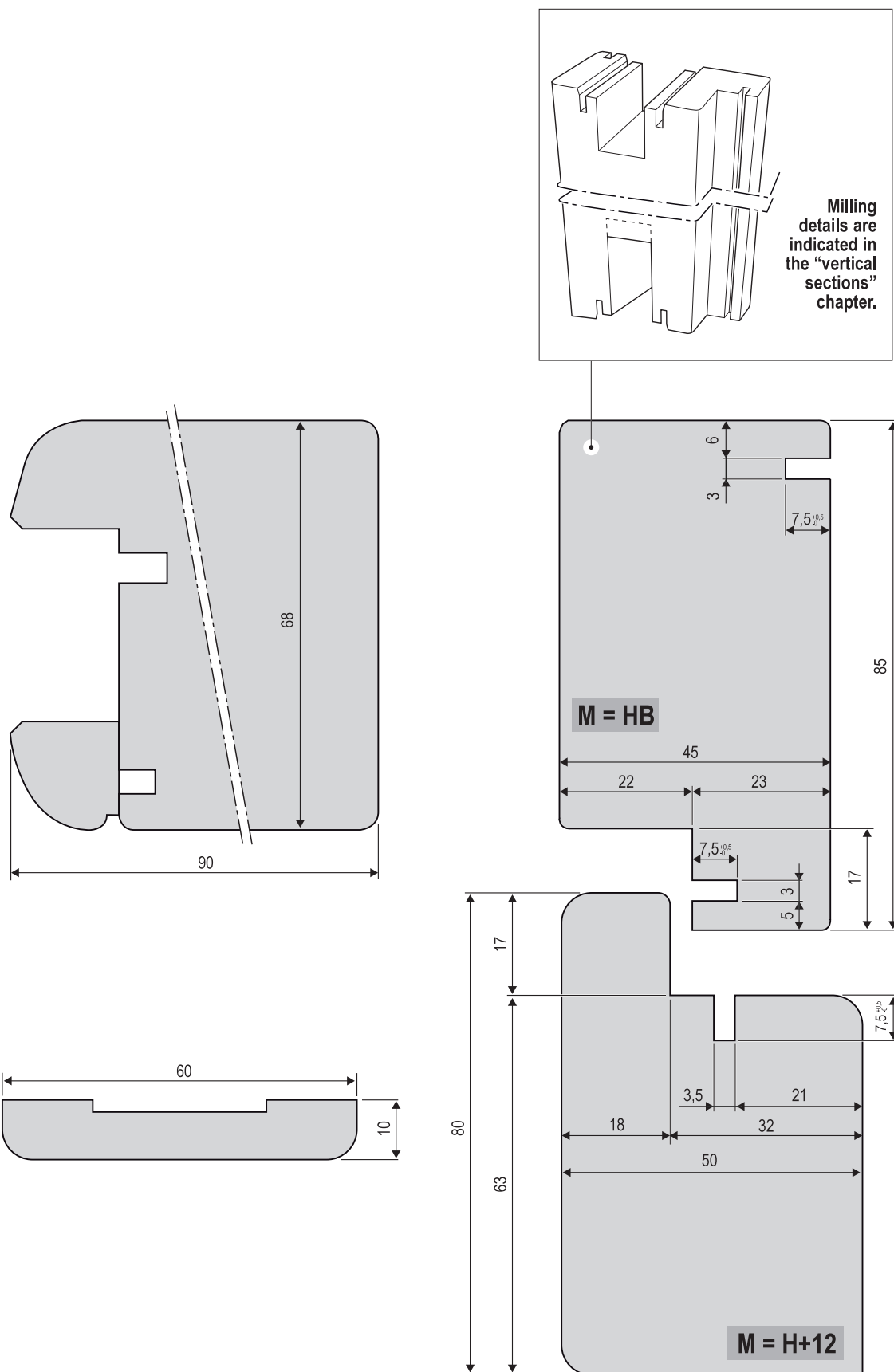

Wood detailing: vertical sections

Scale 1:1

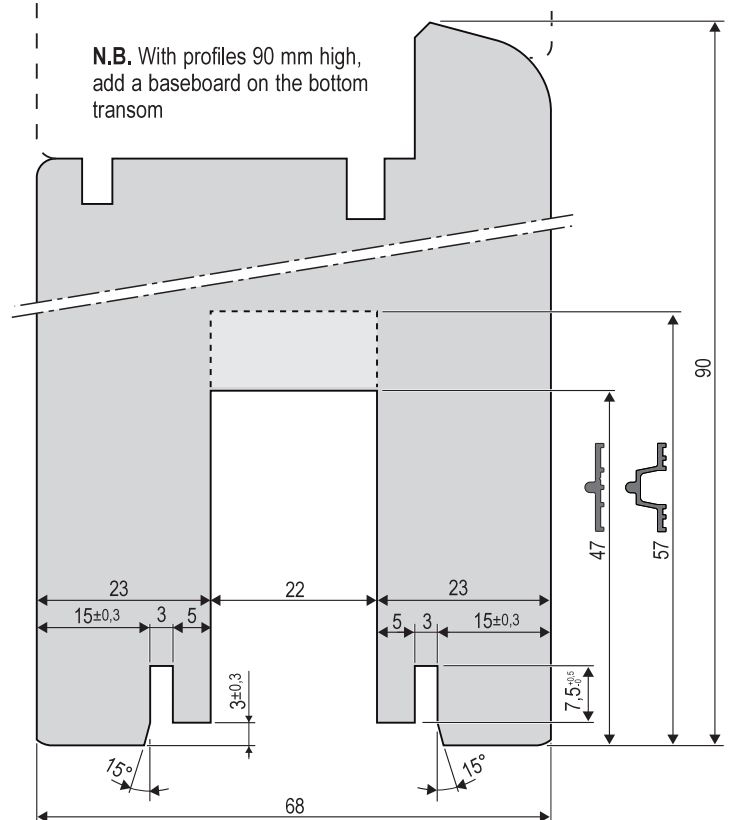
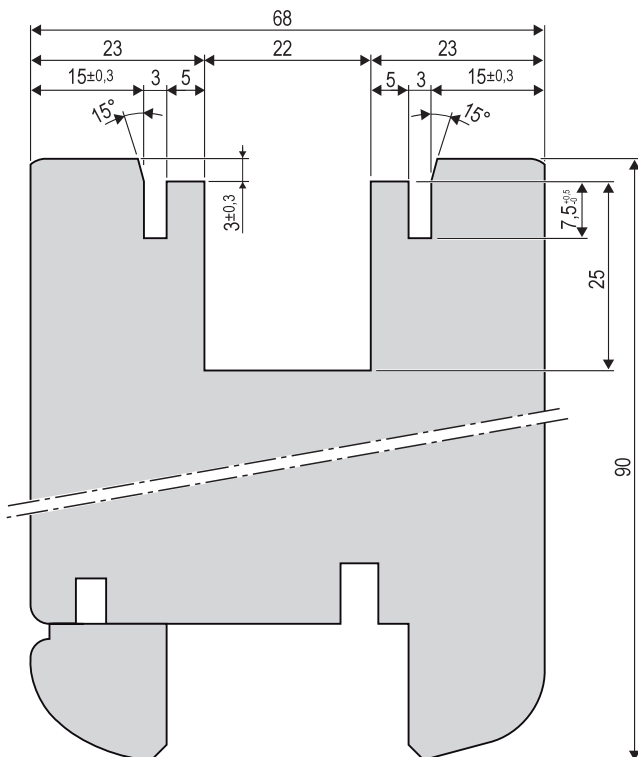
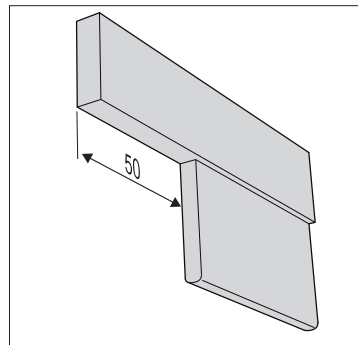
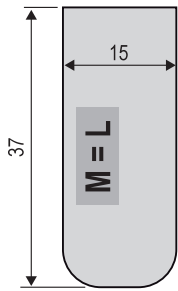
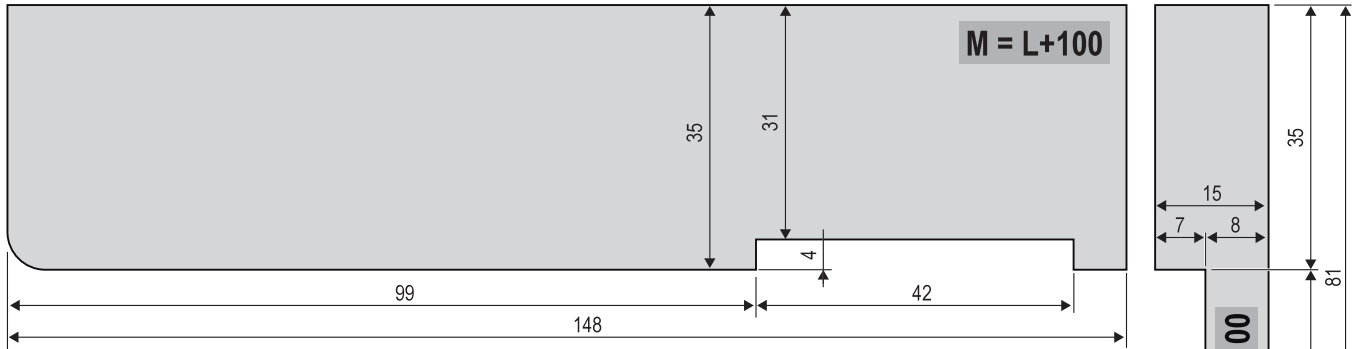
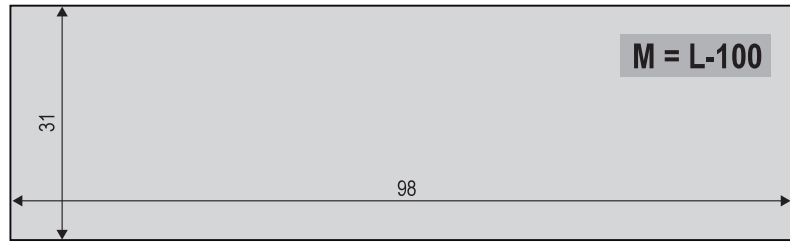

Horizontal section : solution with coaxial sash - layout E

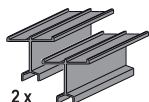
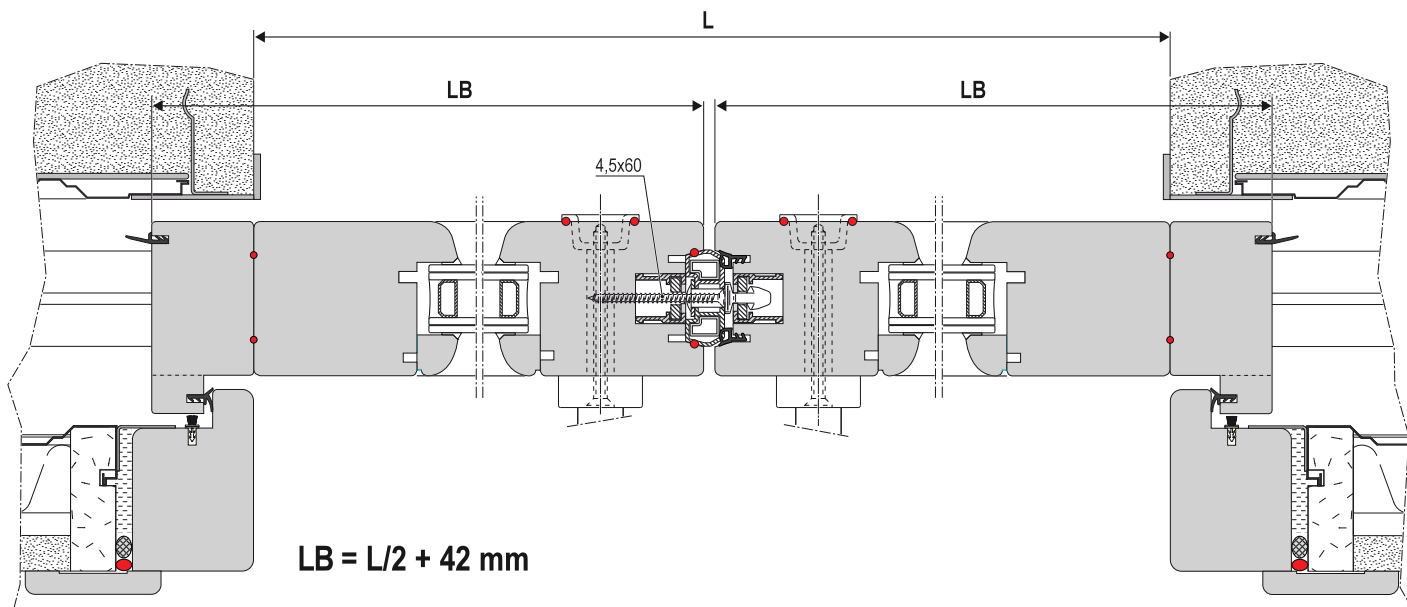

$M = L + 39$



$M = L + 39$

Wood detailing: vertical section - Layout E

Scale 1:1

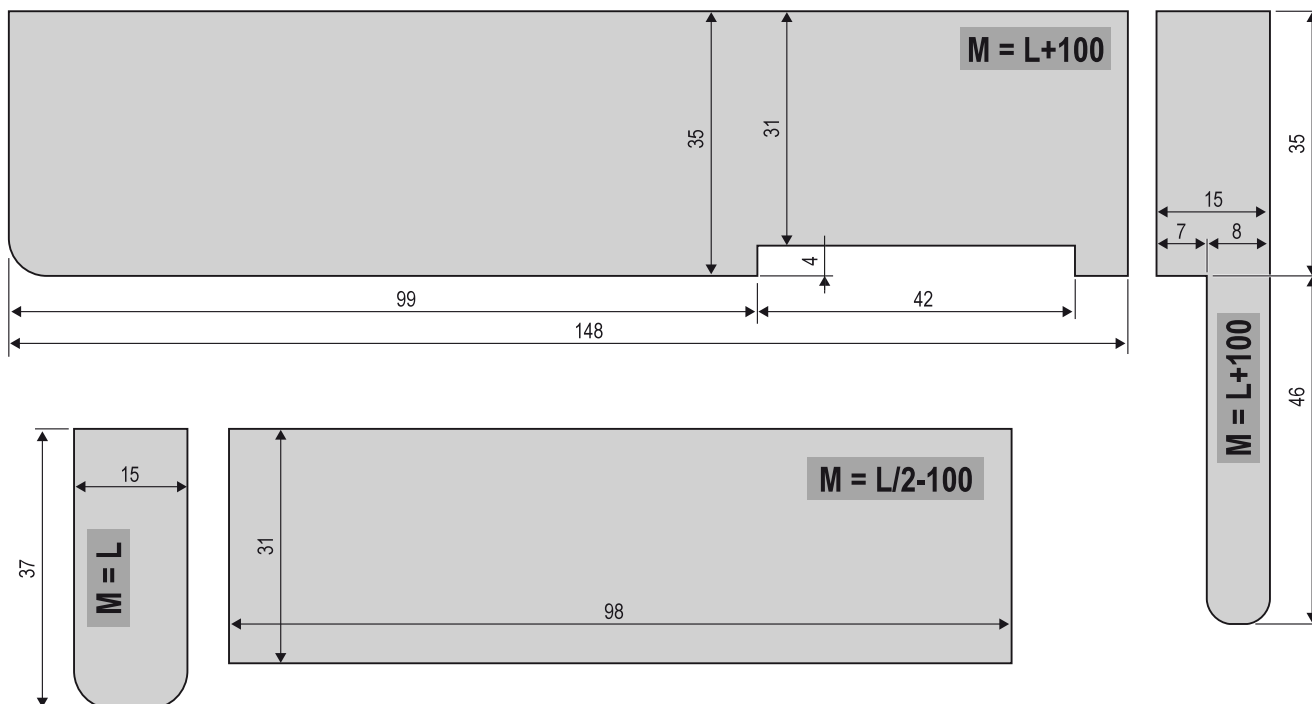

Wood detailing: horizontal section central point - Layout E

Scale 1:1

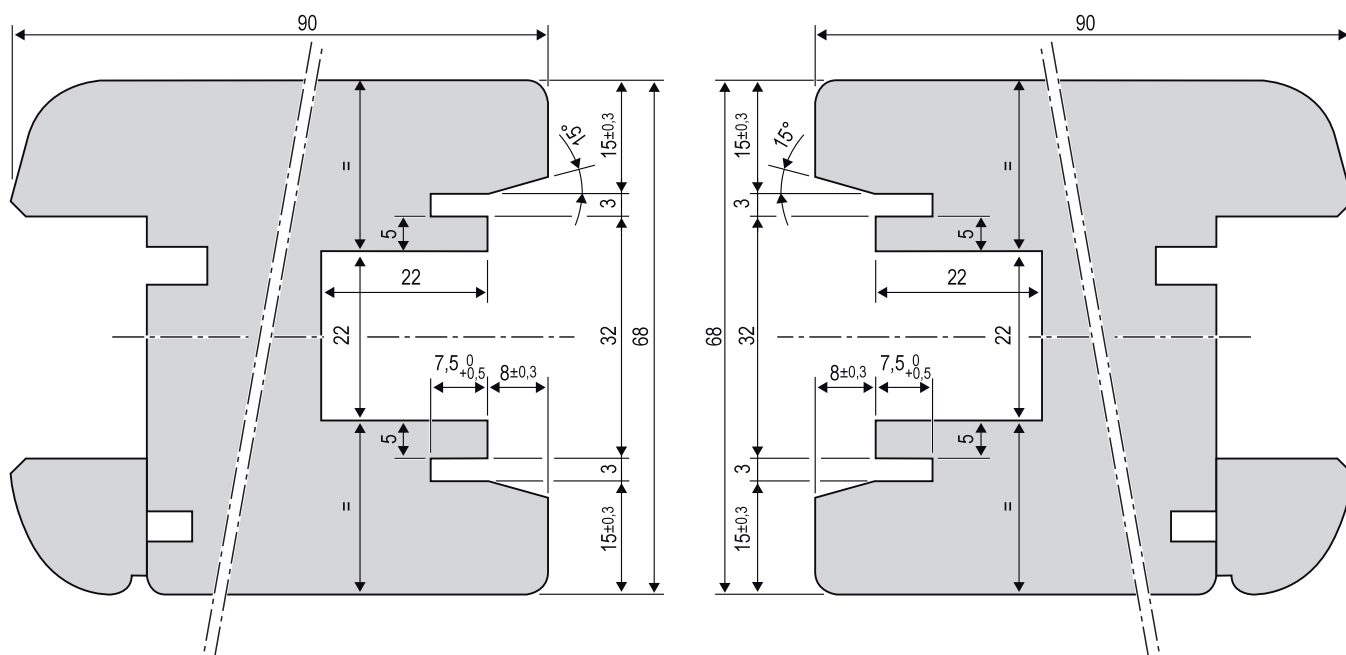

Mounting carriages, lock and accessories

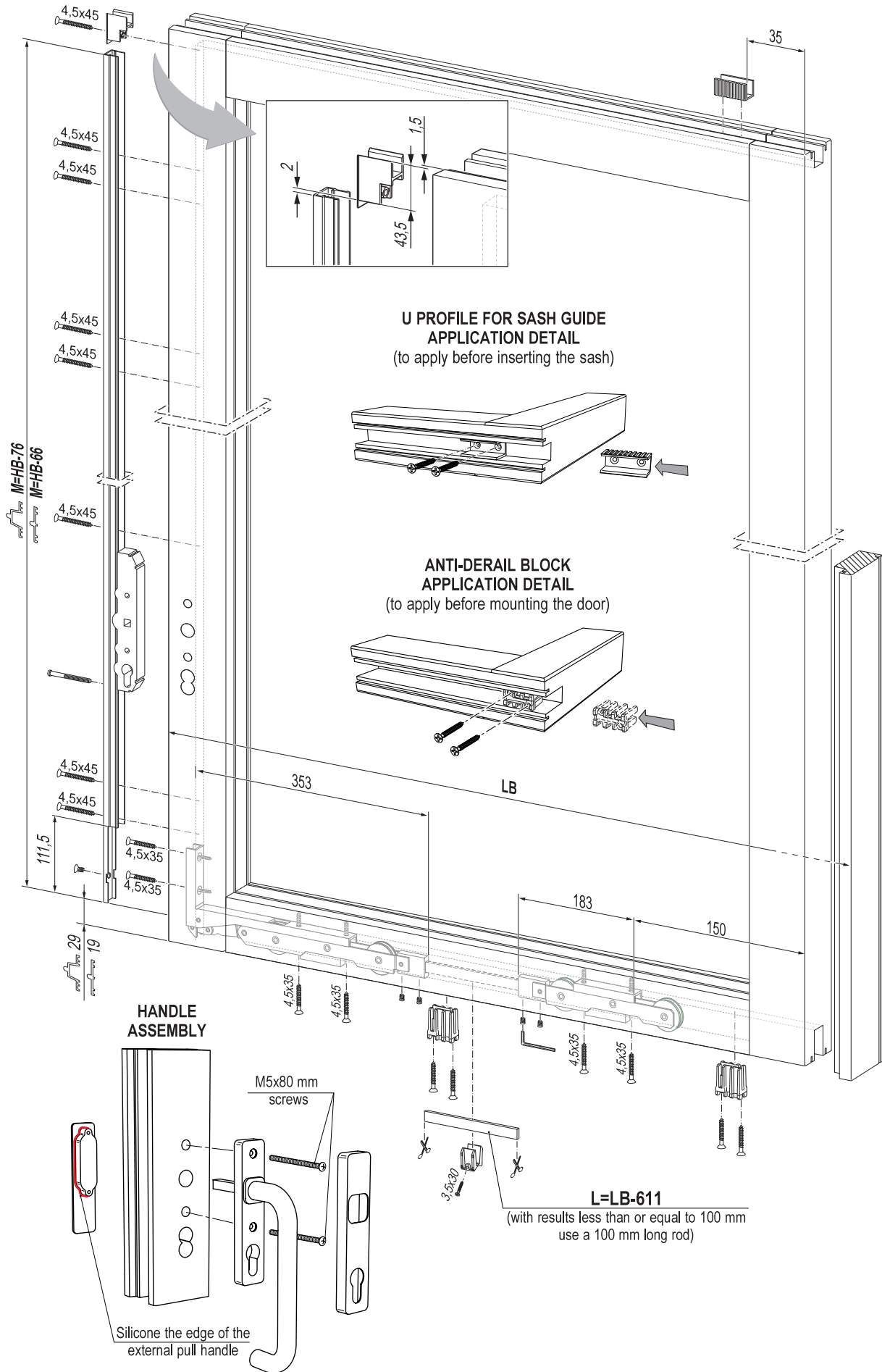

Locking pins assembly

PIN DISTANCE		
GR	A	B
1	450	-
2	850	-
3	980	1450
4	980	1600

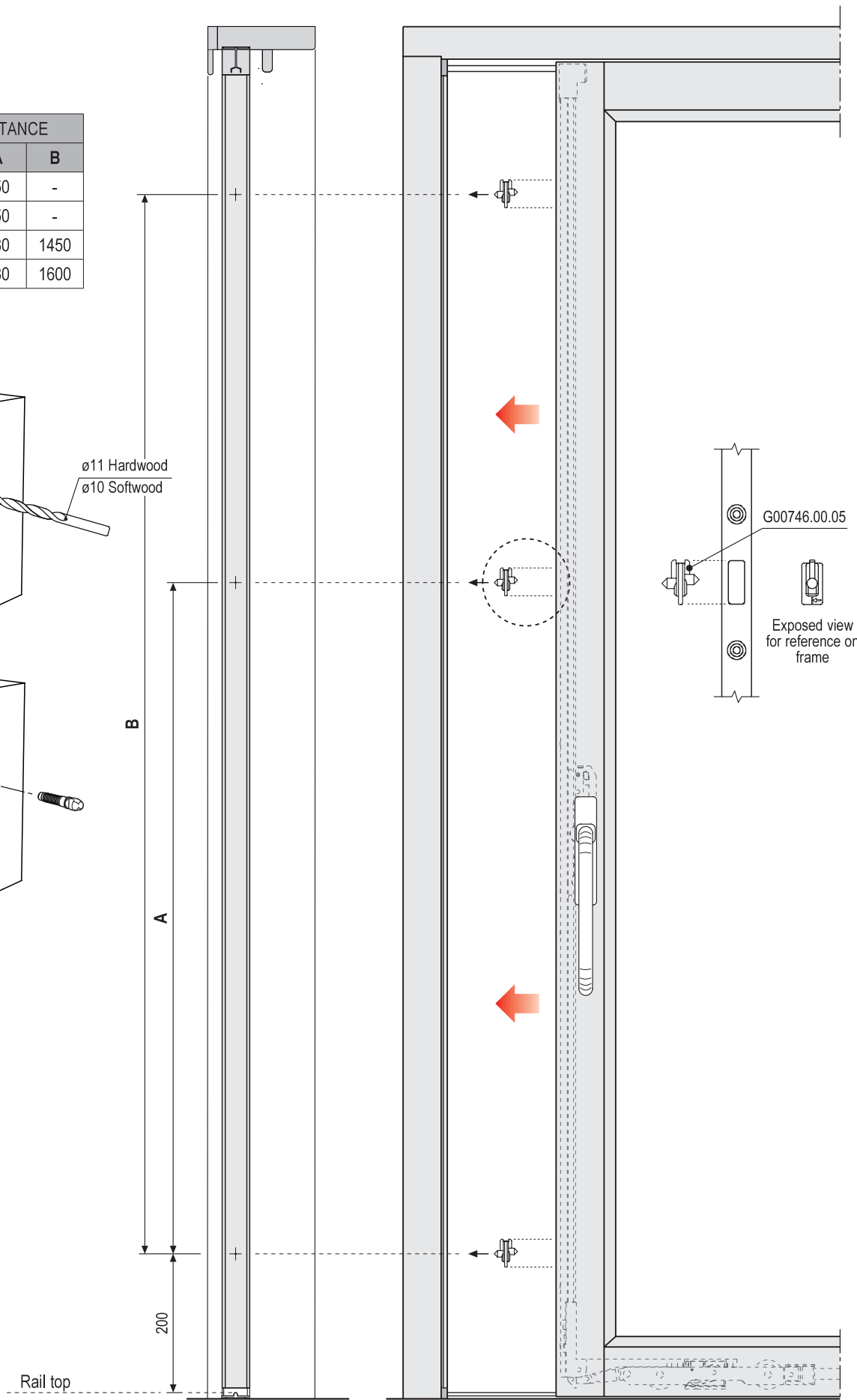
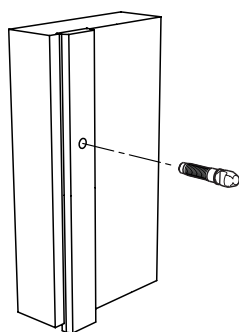
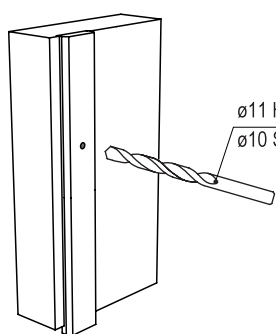

Locking profile for central point with symmetric coaxial sashes detail

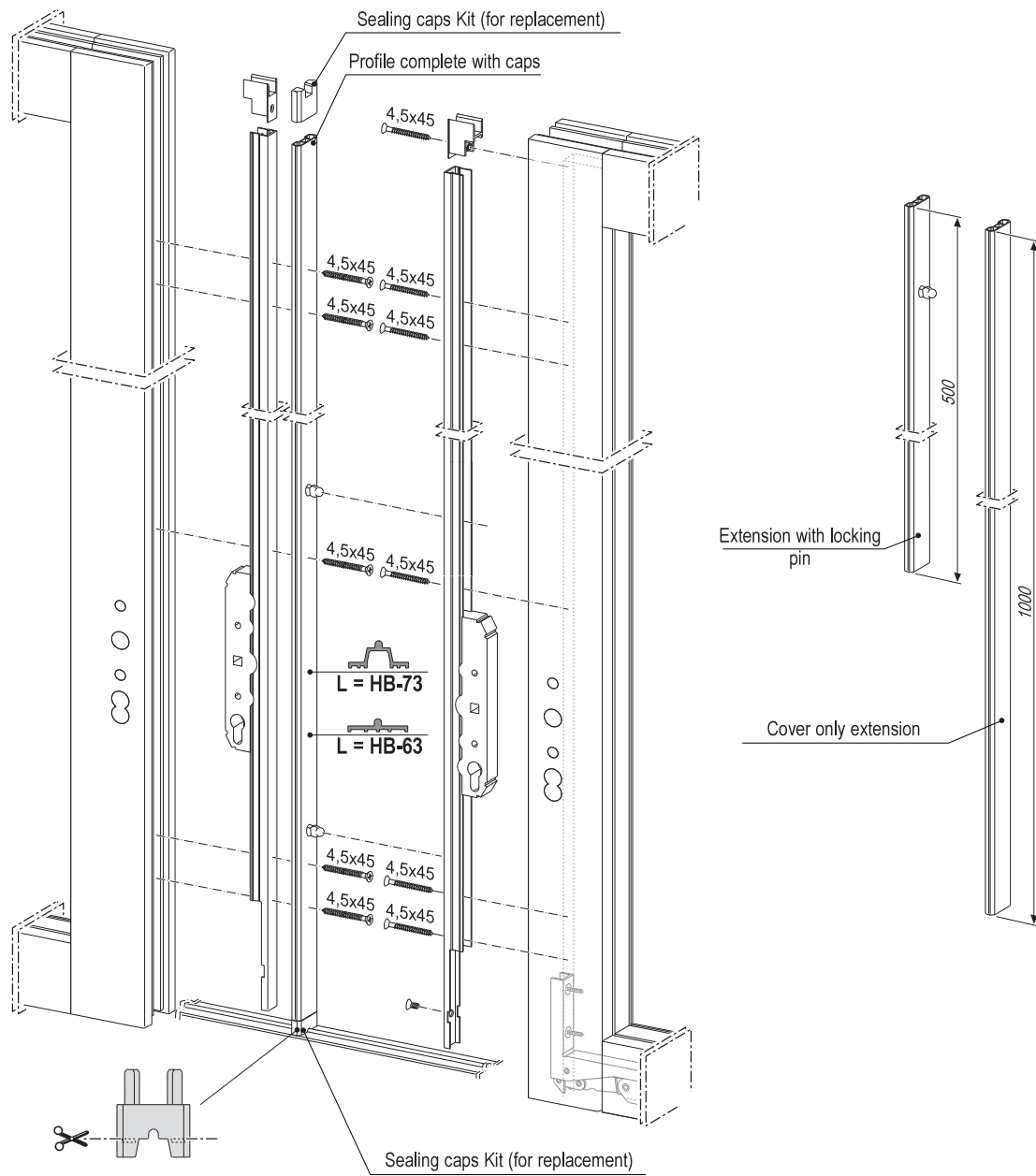



Steps to take for factory process control (FPC)

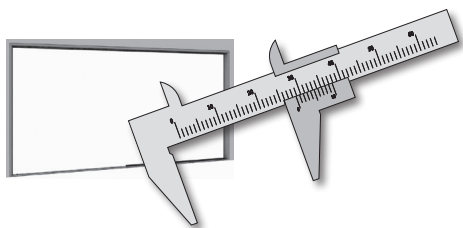

Sash component measurements and techniques for air-water tightness

- 1 - Measure the length and width of the top rail and the vertical jambs.
- 2 - Check that the width and depth of the milled housing for the aluminium top guide and the wooden listels conform to the instructions included in this technical manual.
- 3 - Verify the width and length of the listels.

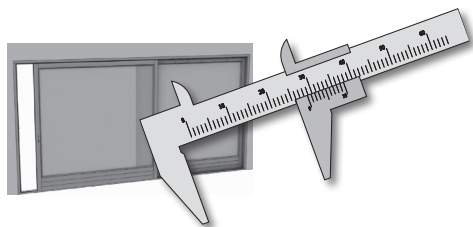

Frame component measurements and techniques for air-water tightness

- 1 - Based on the frame measurements, calculate, according to the instructions provided in the technical manual, the measurement of the sashes (LxH) and check that the dimensions of the sash produced correspond to those calculated.
- 2 - Verify the orthogonality (square) of the sashes by measuring the diagonals: it is very important that they are the same for correct operation and closing.
- 3 - Verify that the thickness of the sash is exactly 68 mm.
- 4 - Check that the width of the milled housings for the carriages is 22 mm and make sure that they are exactly in the centreline of the 68 mm thickness.
- 5 - Check the depth of the milled housings for the gaskets, making sure that they are free from dirt and paint, or glue residue.
- 6 - Check the depth and position of the lock hole.
- 7 - Control the coplanarity of the bottom jamb/transom joints of both leaves. Level with stucco if required, in order not to compromise the seal.
- 8 - The double glazing sheets should have silicone applied on both on the rebate support as well as around the outer perimeter.
- 9 - Silicone the inner glazing beads or use specific gaskets.
- 10 - Apply a silicone bead inside the groove for the bottom outer gasket before inserting it.



Alban Giacomo SpA

Headquarters:

Via A. De Gasperi, 75
36060 Romano d'Ezzelino
(Vicenza) Italy

Warehouse:

Via Col Beretta, 4
36022 Cassola (VI)

Cylinders plant:

Via S. Bortolo, 44
36020 Pove del Grappa (VI)

Tel. +39 0424 832 832

www.agb.it - info@agb.it