

XC motorised lock with pins

Article	Ref.	Description	Material	Use	Fastening
Motorised locks	①	Motorised lock for sashes up to 440 kg. For higher sashes, please use 2 locks.	Forend: aluminium Rod: steel	Choose the lock according to the jamb width and the sliding sash height. Backsets available: 27,5 and 37,5 mm in 3 different heights (see the table).	4,5x45 mm screws.

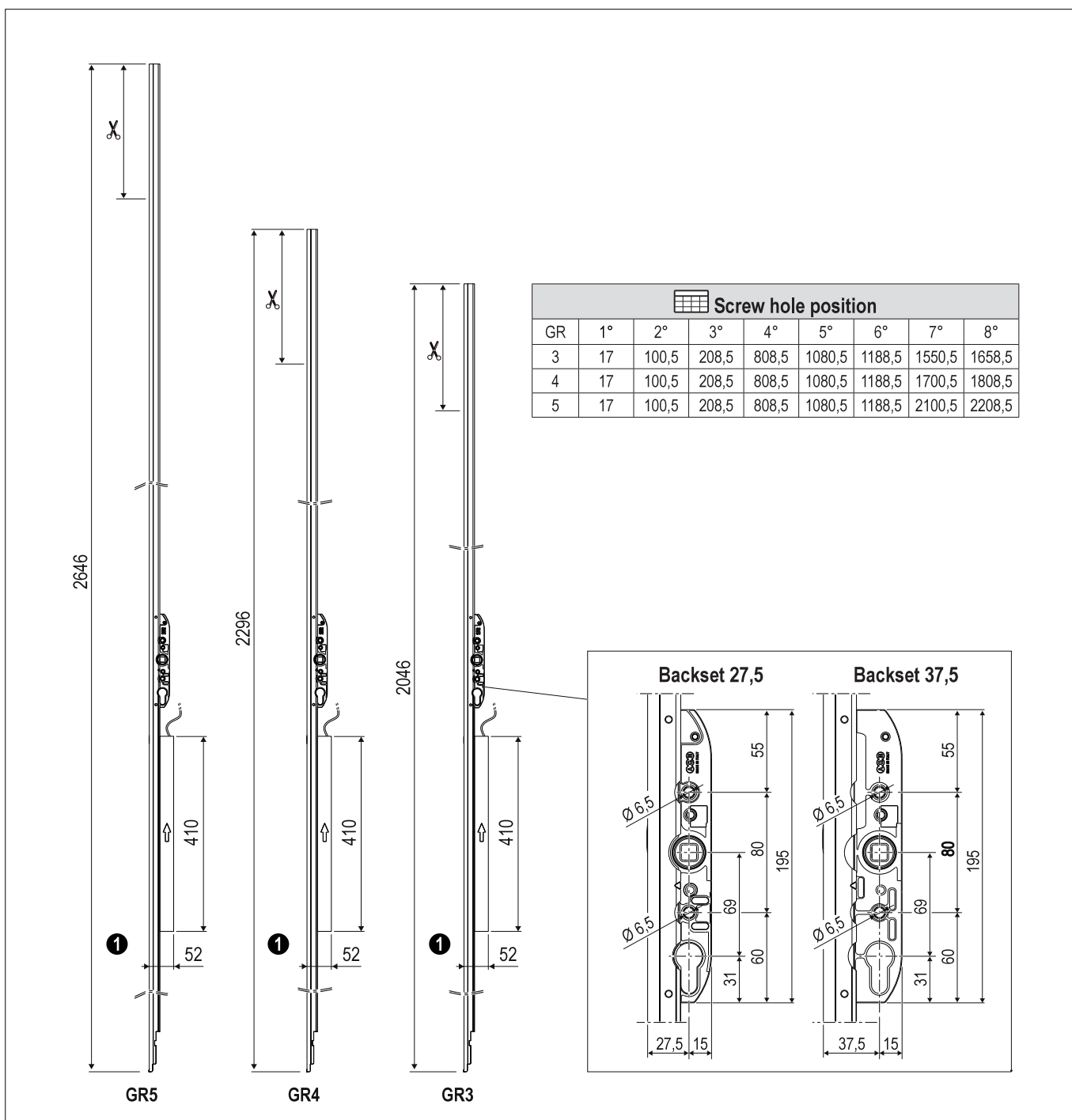

XC motorised lock with pins

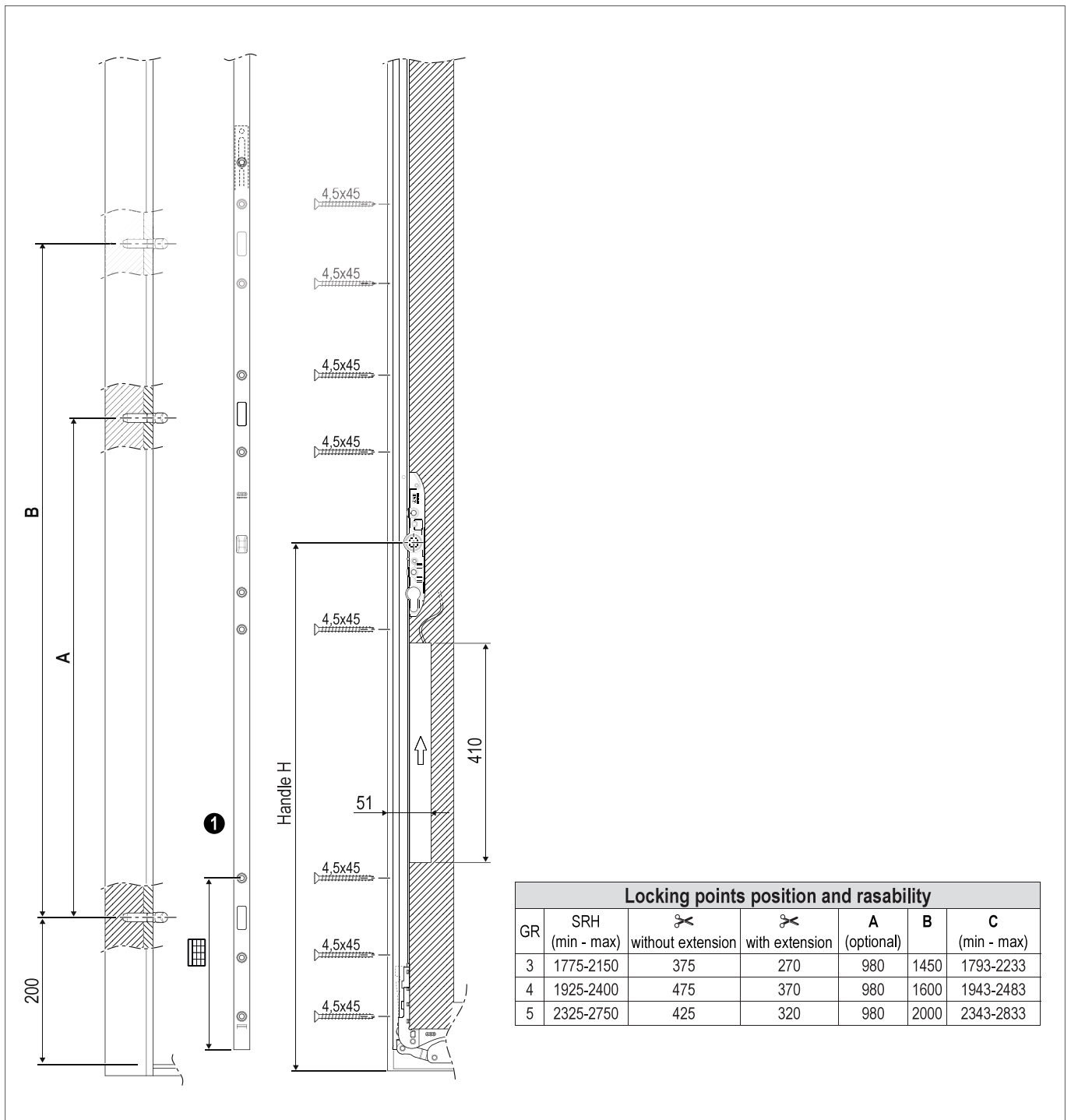

Locking points position and rasability						
GR	SRH (min - max)	✂ without extension	✂ with extension	A (optional)	B	C (min - max)
3	1775-2150	375	270	980	1450	1793-2233
4	1925-2400	475	370	980	1600	1943-2483
5	2325-2750	425	320	980	2000	2343-2833

XC motorised lock with pins

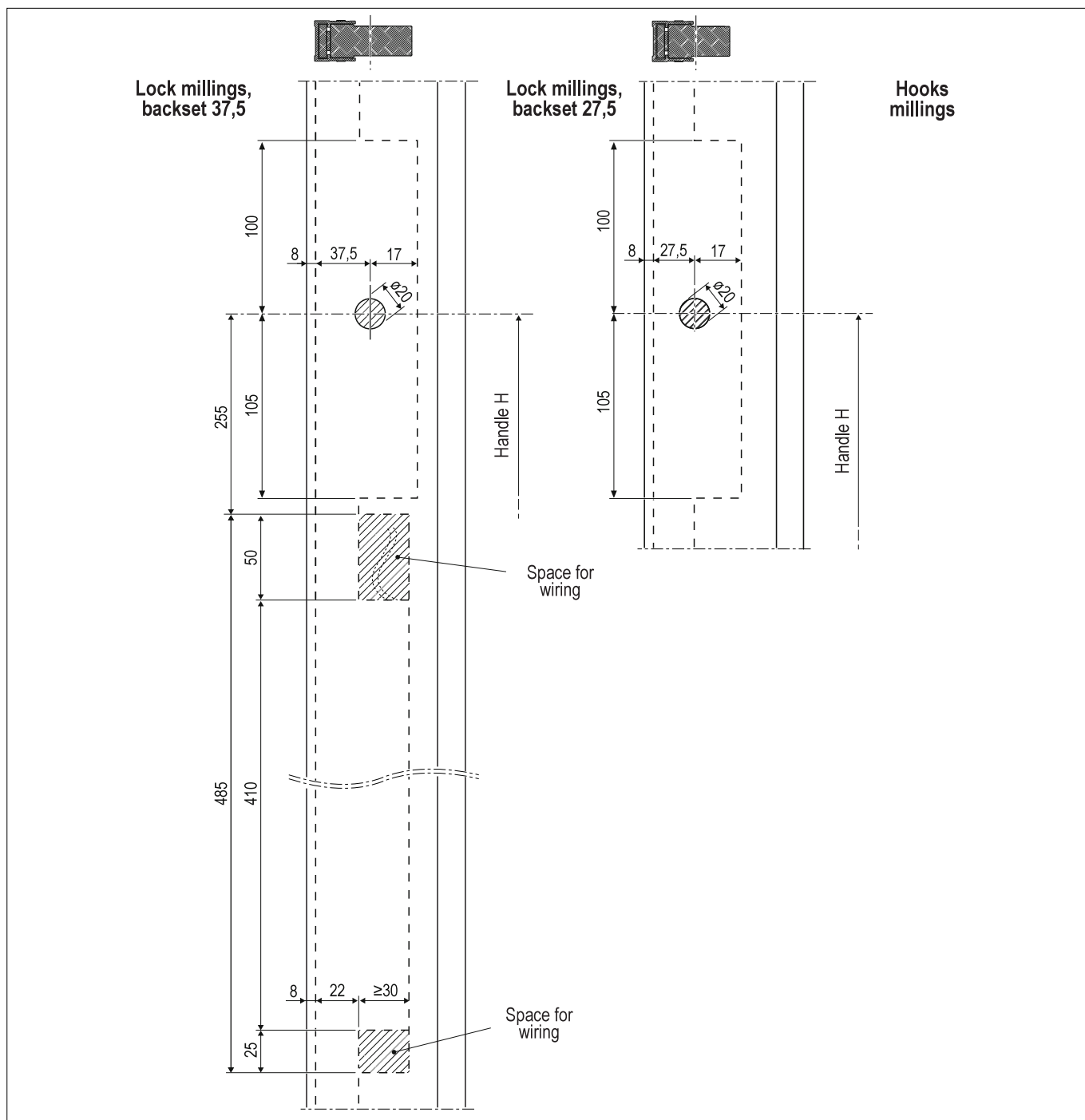

Ref.	Article	GR	Article code, in Silver	Article code, in Electrocoulour	SRH	Handle H	Lock height
1	Lock 440 Kg Backset 27,5	3	GM4027.03.01	GM4027.03.02	1775-2150	1000/1010	2046
		4	GM4027.04.01	GM4027.04.02	1925-2400	1000/1010	2296
		5	GM4027.05.01	GM4027.05.02	2325-2750	1000/1010	2646
	Lock 440 kg Backset 37,5	3	GM4037.03.01	GM4037.03.02	1775-2150	1000/1010	2046
		4	GM4037.04.01	GM4037.04.02	1925-2400	1000/1010	2296
5		GM4037.05.01	GM4037.05.02	2325-2750	1000/1010	2646	

XC motorised lock with hooks

Article	Ref.	Description	Material	Use	Fastening
Motorised hook lock	①	Motorised lock for sashes up to 440 kg. For higher sashes, please use 2 locks.	Forend: aluminium Rod: steel Hooks: steel	Choose the lock according to the jamb width and the sliding sash height. Backsets available: 27,5 and 37,5 mm in 3 different heights (see the table).	4,5x45 mm screws

Screw hole position								
GR	1°	2°	3°	4°	5°	6°	7°	8°
3	17	100,5	304,5	808,5	1080,5	1274,5	1458,5	1658,5
4	17	100,5	304,5	808,5	1080,5	1274,5	1608,5	1808,5
5	17	100,5	304,5	808,5	1080,5	1274,5	2008,5	2208,5

Note. Please do not use the 4th screw hole.

XC motorised lock with hooks

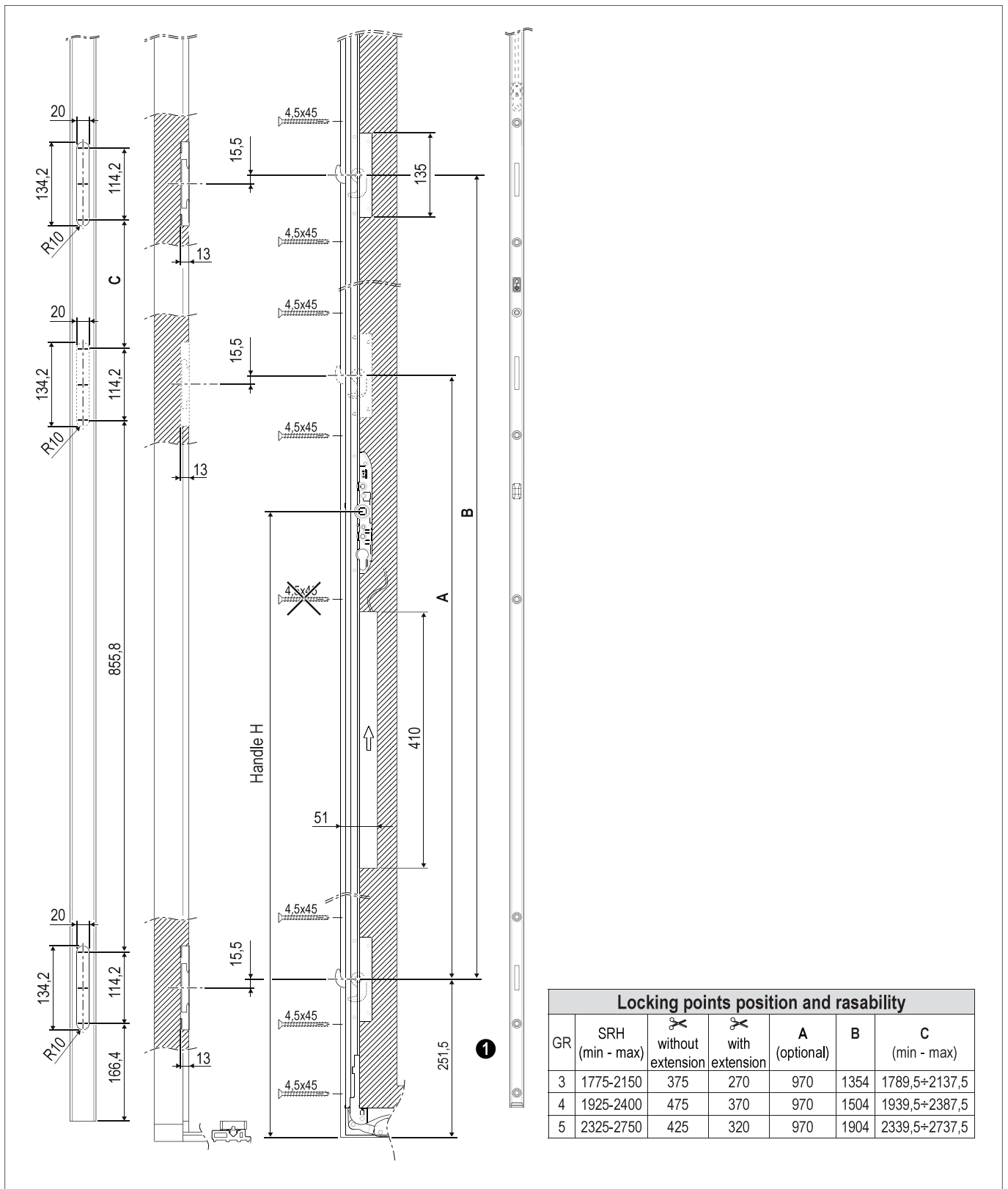

XC motorised lock with hooks

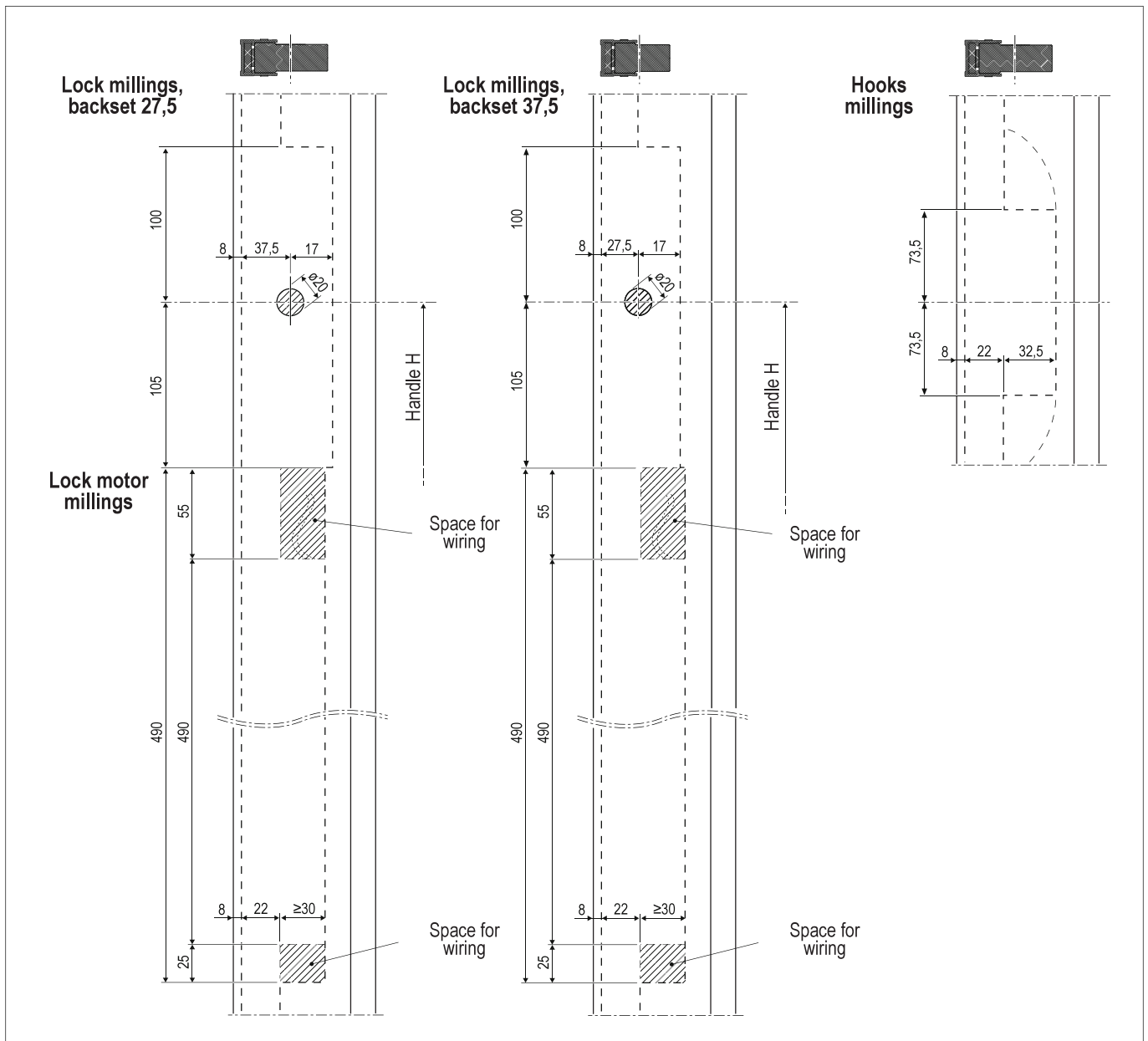

Ref.	Article	GR	Article code, in Silver	Article code, in Electrocolour	SRH	Handle H	Lock height
❶	Motorised lock backset 27,5	3	GM3927.03.01	GM3927.03.02	1775-2150	1000/1010	2046
		4	GM3927.04.01	GM3927.04.02	1925-2400	1000/1010	2296
		5	GM3927.05.01	GM3927.05.02	2325-2750	1000/1010	2646
	Motorised lock backset 37,5	3	GM3937.03.01	GM3937.03.02	1775-2150	1000/1010	2046
		4	GM3937.04.01	GM3937.04.02	1925-2400	1000/1010	2296
		5	GM3937.05.01	GM3937.05.02	2325-2750	1000/1010	2646